



## UNIVERSAL 300



### REICH BANDSAW UNIVERSAL 300

- "CE"-certified and "GS"-approved
- According the EEC Safety regulations
- with continuous welded table to the housing.
- Motor stops automatically when opening the doors or covers.
- With maintenance free electronic brake motor.
- Scraper of wheels installed and removable without tools
- Band saw guide in table specially coated and removable without tools.
- Gas damper provides always correct tension of blade.
- All parts rustfree!
- Blade guided in the wheels, therefore cannot jump down from wheel.
- By additional grooves the crossing of teeth will be not affected by the wheels.
- Self-carrying frame, strong table, wheels, waste bin, portion-gauge in stainless steel inoxidable.
- Safety magnet in hygienic design.

- Control device for safety switches.
- Easy to maintain contactor box with standard parts.
- Large grip for ergonomic opening of doors
- Voltage : 230/400 V / 50 cycles
- Connection load : 1,5 kW
- Revolutions : 1500 / min.
- Cutting speed : 22 m/sec
- Dimensions table : 770 x 710 mm
- Height of table : 900 mm
- Width of cutting : 280 mm
- Height of cutting : 345 mm
- Saw blade : 2490 x 16 x 0.6 mm
- Housing : Stainless steel
- Dimension : 770 x 710 x 1690 mm
- Netweight : 160 kg
- Grossweight : 180 kg on pallet
- Seaworthy packed : 250 kg in wooden case.
- Dimension of box : 1000 x 1000 x 1900 mm

#### C.-E. REICH GMBH

Oberer Wasen 13

D-73630 Remshalden

Phone.: +49-7151-79899

Fax: + 49-7151-74692

e-mail: [cereichgmbh@t-online.de](mailto:cereichgmbh@t-online.de)

homepage: <http://www.reich-fleischereimaschinen.de>

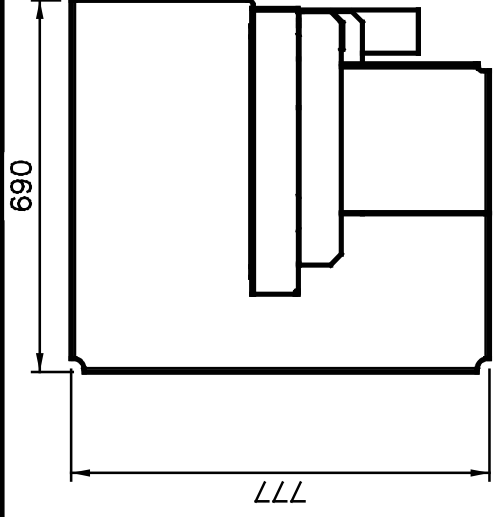

Motorleistung / Power: 1,5 kW  
 Durchmesser der Rollen = 300 mm  
 Diameter of wheels = 300 mm  
 Saagebandabmessung: 2.490 mm  
 Saw blade dimension: 2.490 mm  
 Höhenverstellbare Blattführung.  
 In height adjustable upper saw blade guidance.  
 Verstaerkte Bremsinheit VB 400-30 L  
 Reinforced brake system VB 400-30L

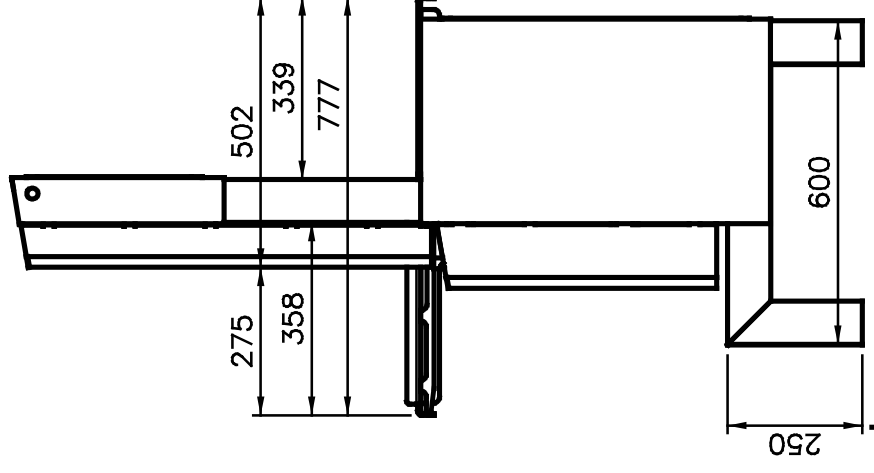
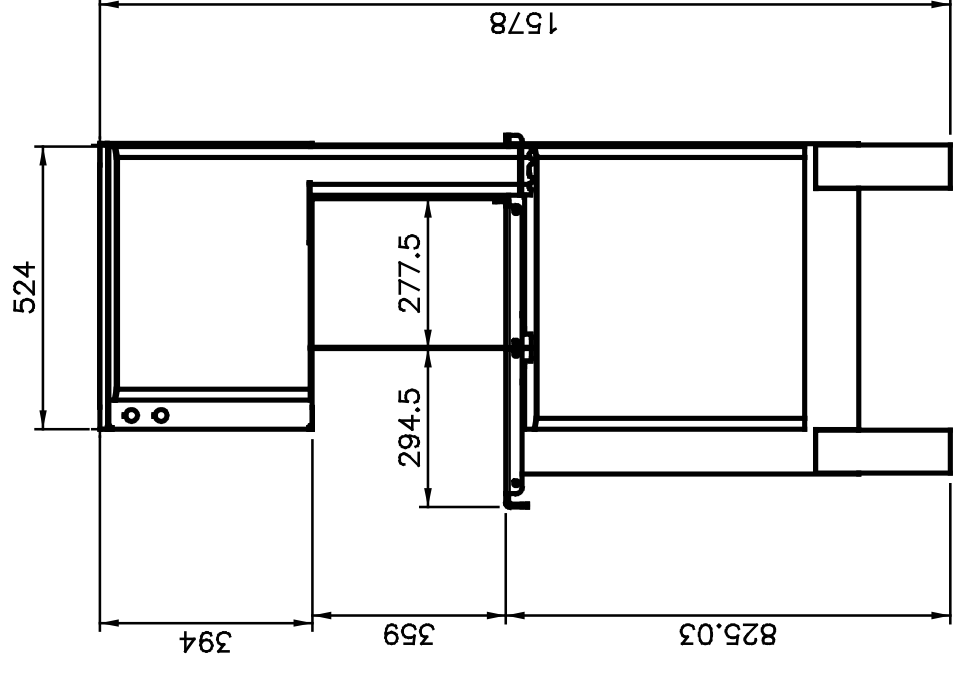
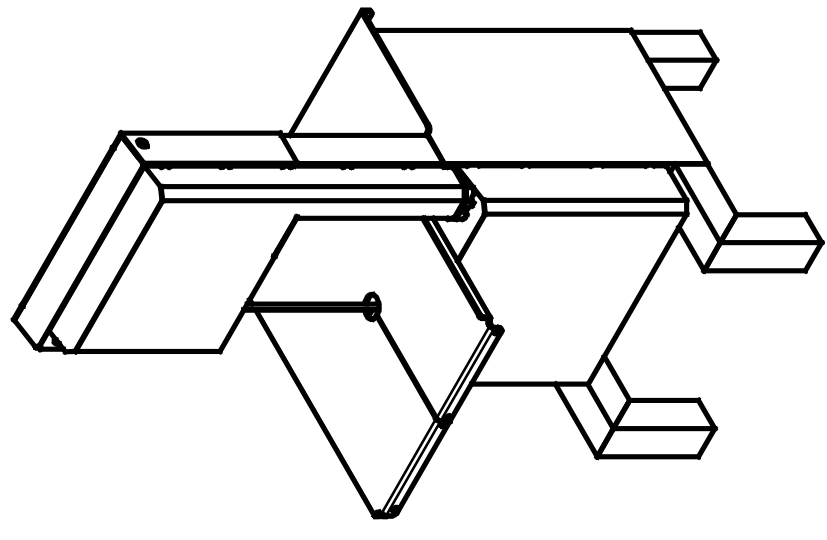

														Titel REICH UNIVERSAL 300			
														Incl. Beschreibung		von Datum	
														Projektnummer		Zeichnungsnummer	
														S-100-300			
														Mensch		Datum	
														Berarb.			
														Gepr.			
														Norm			